

FAROLAMP LED



FAROLAMP LED S

FAROLAMP LED P

Cupole / Domes / Dômes



Base

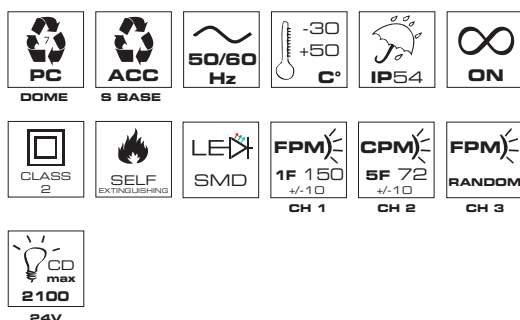

FAROLAMP LED

| | |
|--------|---------|
| V ACDC | 12 ÷ 24 |
| mA | 450 700 |

Codici / Codes

FAROLAMP LED

| BASES | Color | Code | Code | Code | Code |
|-------|--------|-------|-------|-------|-------|
| S | Orange | 85092 | 85093 | 85094 | 85095 |
| P | Orange | 85225 | 85226 | 85227 | 85228 |

RICAMBI CUPOLE / SPARE DOMES / DOMES DE RCHANGE

| | | | |
|--------|-------|-------|--------|
| Orange | Red | Green | Yellow |
| 71325 | 71328 | 71329 | 71293 |

Luce a LED multifunzionale, sviluppata con tecnologia multicanale. FAROLAMP LED dispone di 3 effetti luce: luce lampeggiante, effetto strobo, random. Disponibile con due basi di fissaggio (standard S e a palo P).

Tensione operativa

12/24V ACDC +/-10%

Caratteristiche meccaniche

Base in acciaio ad alta resistenza agli impatti e fissaggio tramite viteria standard non fornita (versione base S). Cupola in policarbonato autoestinguento.

Caratteristiche luminose

2x LED SuperBright, consentono tre effetti luminosi: luce lampeggiante (flash singolo 1F), effetto stroboscopico 5F, luce random (effetto unico nel suo genere con lampeggio casuale che consente di aumentare la capacità del dispositivo di attirare l'attenzione).

I diversi effetti luminosi sono gestiti tramite contatti elettrici indipendenti.

La cupola a lente di Fresnel consente di magnificare il fascio luminoso di questi dispositivi.

Certificazioni / Certifications

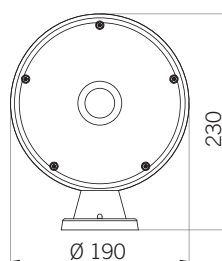
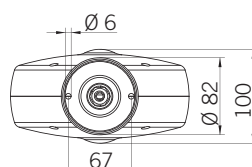

FAROLAMP LED S

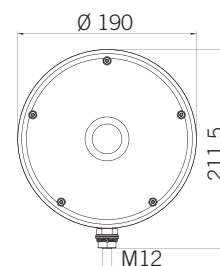

FAROLAMP LED P



Multifunctional LED beacon, developed with a multichannel technology. FAROLAMP LED allows three separate light effects: flashing, strobe and random.

Two bases available (standard S and pole mount P).

Voltages

12/24V ACDC +/-10%

Mechanical features

High impact resistance steel base. Screw mounting, screws not included (S base version). Self-extinguishing polycarbonate dome.

Optical features

2x SuperBright LEDs allow three luminous effects: flashing light (single flash 1F), strobe effect 5F, random light (a unique random effect consisting in an uneven flashing pattern, augmenting the ability of catching attention).

Light effects are controllable via independent electric contacts.

The dome-shaped Fresnel lens intensifies the luminous beam of these devices.



Feu à LED multifonction développé sur la base d'une technologie multicanale. FAROLAMP LED dispose de trois divers effets lumineux : lumière clignotante, effet stroboscopique, effet random. Disponible avec deux bases de fixation (standard S et hampe P).

Tension d'utilisation

12/24V ACDC +/-10%

Caractéristiques mécaniques

Base en acier à haute résistance aux chocs et fixation par vis standards non fournies (version base S). Dôme en polycarbonate autoextinguible.

Caractéristiques optiques

2x LED SuperBright, produisent trois effets lumineux: lumière clignotante (simple éclat 1F), effet stroboscopique 5F, effet random (consistant en un clignotement aléatoire, qui permet au dispositif d'augmenter sa capacité d'attirer l'attention).

Les divers effets lumineux sont gérés par connexions électriques indépendantes. Le dôme à lentille de Fresnel permet d'amplifier le faisceau lumineux de ces dispositifs.